

ITE

In-the-Ear Hearing Aids

IIC, CIC, ITC, ITE HS, ITE FS

ZERENA

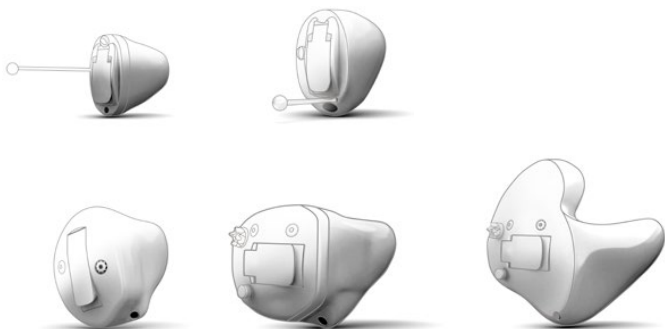

Made for

iPhone | iPad | iPod

*

* only for 2.4 GHz models

Instructions for Use

bernafon[®]
Your hearing • Our passion

Model overview

This booklet is valid for the Bernafon Zerena family in the following hearing aid models, battery sizes, and styles:

Models

- Zerena 9 – ZR9
- Zerena 7 – ZR7
- Zerena 5 – ZR5
- Zerena 3 – ZR3
- Zerena 1 – ZR1

Battery size

- 10
- 312
- 13

2.4 GHz

- Yes
- No

NFMI

- Yes
- No

Styles

- IIC Invisible-In-the-Canal
- CIC Completely-In-the-Canal
- ITC In-the-Canal
- ITE HS In-the-Ear Half Shell
- ITE FS In-the-Ear Full Shell

Introduction to this booklet

This booklet shows you how to use and maintain your new hearing aid. Please read the booklet carefully including the warning sections. This will help you to achieve the full benefit of your new hearing aid.

Your hearing care professional has adjusted the hearing aid to meet your needs. If you have further questions, please contact your hearing care professional.

Intended use

The hearing aid is intended to amplify and transmit sound to the ear and thereby compensate for impaired hearing within mild to severe hearing loss. This hearing aid is intended for use by adults and children older than 36 months.

IMPORTANT NOTICE

The hearing aid amplification is uniquely adjusted and optimized to your hearing capabilities during the hearing aid fitting performed by your hearing care professional.

Identify your hearing aid

For your in-the-ear hearing aid, there are several different styles available with different battery sizes. Please see the model overview for your style and battery size. This will make it easier for you to navigate through this booklet.

Table of contents

Size 10 battery (CIC shown)	10
Size 312 battery (ITC shown)	11
Size 13 battery (HS shown)	12
Identify left and right hearing aid	13
MultiTool for handling batteries and cleaning	14
Turn the hearing aid ON and OFF	15
When to replace a battery	16
Replace the battery	17
Insert the hearing aid	19
Remove your hearing aid	20
Caring for your hearing aid	21
Filter replacement	23
Replace ProWax miniFit filter	24
Replace T-Cap filter	25
Replace O-Cap filter	26
Flight mode	27

Optional features and accessories	28
Change programs	29
Change volume with push button	31
Change volume with volume wheel	32
Mute the hearing aid	33
Using hearing aids with iPhone, iPad, and iPod touch	34
Pairing hearing aid with iPhone	35
Re-connect your hearing aids to your iPhone, iPad, or iPod touch	38
Bernafon EasyControl-A app	39
Wireless accessories	41
Other options (optional)	42
Tinnitus SoundSupport (optional)	43
Guidelines for tinnitus sound generator users	44
Sound options and volume adjustment	45
Change volume with push button	47
Change volume with volume wheel	48
Hearing aid with Bluetooth®	49

Limitation on use time	50
Important information for hearing care professionals about Tinnitus SoundSupport	51
Warnings related to Tinnitus SoundSupport	53
General warnings	55
Troubleshooting guide	60
Water & dust resistance (IP68)	62
Conditions of use	64
Warranty certificate	65
International warranty	66
Technical information	67
Your individual hearing aid settings	71

Size 10 battery (CIC shown)

What it is and does

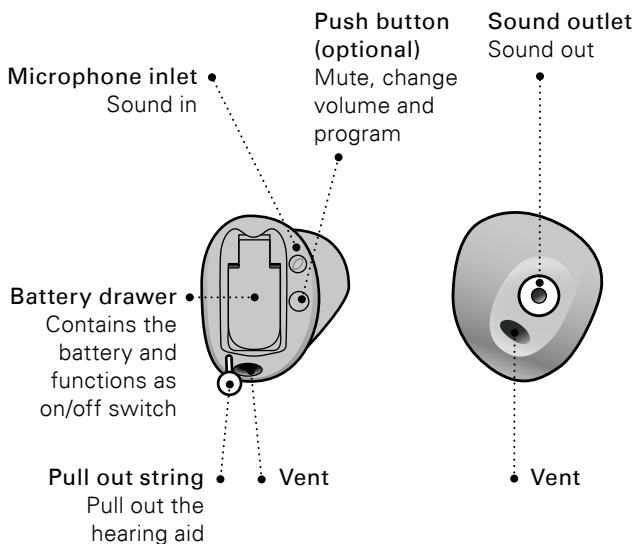

Components may be positioned differently on your hearing aid.

Size 312 battery (ITC shown)

What it is and does

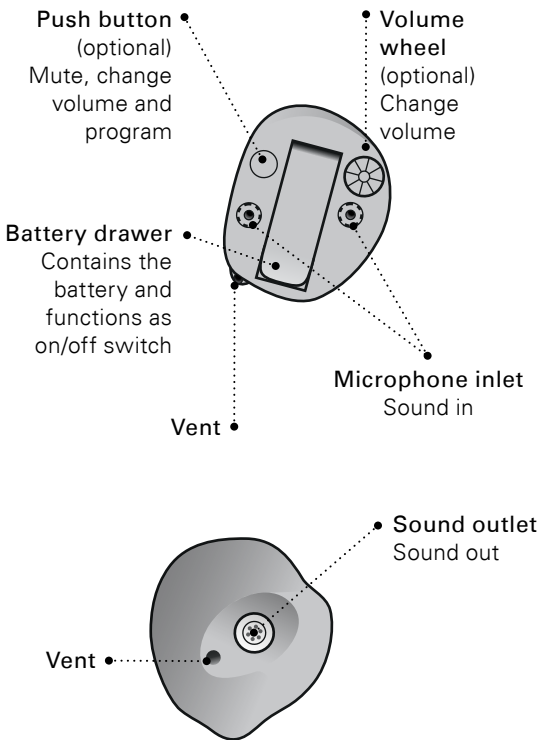

Size 13 battery (ITE HS shown)

What it is and does

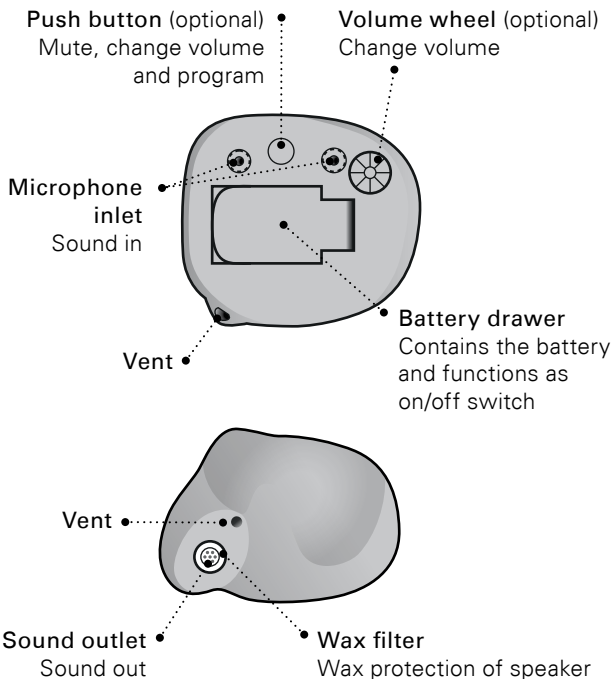

Components may be positioned differently on your hearing aid.

Identify left and right hearing aid

It is important to distinguish between the left and the right hearing aid as they might be shaped and programmed differently.

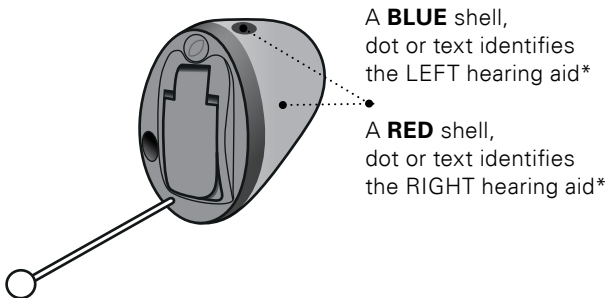

* Shell and dot is only available for IIC

MultiTool for handling batteries and cleaning

The MultiTool contains a magnet that makes it easier to replace the battery in the hearing aid. It also contains a brush and a wire loop for cleaning and removing ear wax from your earpiece. If you need a new MultiTool, please contact your hearing care professional.

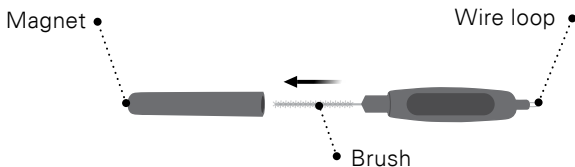

IMPORTANT NOTICE

The MultiTool has a built-in magnet. Keep the MultiTool at least 30 cm away from credit cards and other magnetically sensitive devices.

Turn the hearing aid ON and OFF

The battery drawer is also used to switch the hearing aid on and off. To preserve the battery, make sure your hearing aid is switched off when you are not wearing it. If you wish to return to the standard settings of the hearing aid programmed by your hearing care professional, simply open and then close the battery drawer.

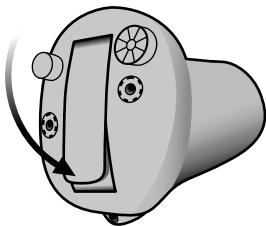

Turn ON

Close the battery drawer with the battery in place

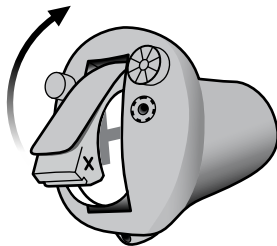

Turn OFF

Open the battery drawer



Whenever the hearing instrument is not in use for longer periods of time (e.g., at night), fully open the battery door to allow air to circulate and to make sure the hearing aid does not drain the battery.

When to replace a battery

When it is time to replace the battery, you will hear three beeps repeated at moderate intervals until the battery runs out.



Three beeps*

The battery is running low



Four beeps

The battery has run out

Battery tip

To make sure the hearing aid is always working, bring spare batteries with you, or replace the battery before you leave home.

* If your hearing aid has Bluetooth® this will be turned off and it will not be possible to use wireless accessories.

The Bluetooth® word mark and logos are registered trademarks owned by the Bluetooth SIG, Inc. and any use of such marks by William Demant Holding A/S is under license. Other trademarks and trade names are those of their respective owners.



Batteries need to be replaced more often if you are streaming audio or music to your hearing aids.

Replace the battery

1. Remove

Fully open the battery drawer. Remove the battery.

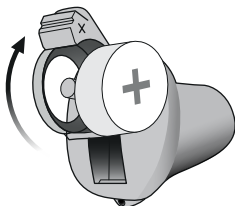

2. Uncover

Remove the sticky label from the + side of the new battery.

Tip:

Wait 2 minutes so that the battery can draw air, to ensure optimal functioning.



3. Insert

Insert the new battery into the battery drawer. Make sure the + side faces the + on the battery drawer.

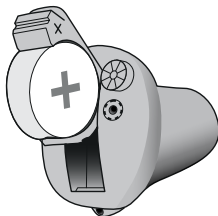

4. Close

Close the battery drawer.
The hearing aid will play a jingle through the earpiece.
Hold the earpiece close to your ear to hear the jingle.

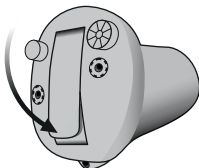

Tip

The MultiTool can be used for battery change.
Use the magnetic end to remove and insert batteries.

The MultiTool is provided by your hearing care professional.

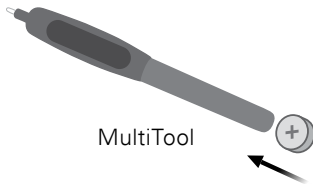

Insert the hearing aid

Step 1

Place the tip of the hearing aid in your ear canal.



Step 2

Gently pull your ear outwards and push the hearing aid into the ear canal, twisting slightly if necessary. Follow the natural contour of the ear canal. Push the hearing aid to make sure it fits comfortably in the ear.



Remove your hearing aid

Hold the hearing aid by the pull-out string (if available). Gently pull the hearing aid from the ear canal.

If your hearing aid doesn't have a pull-out string, you can remove it by pulling on the edge of the hearing aid.

IMPORTANT NOTICE

DO NOT use the battery door as a handle to insert or remove your hearing aid. It is not designed for this purpose.

Caring for your hearing aid

When handling your hearing aid, hold it over a soft surface to avoid damage if you drop it.

Cleaning the hearing aid

Carefully brush away debris from the microphone inlets with a clean brush. Gently brush the surface. Make sure that the filters do not fall off.

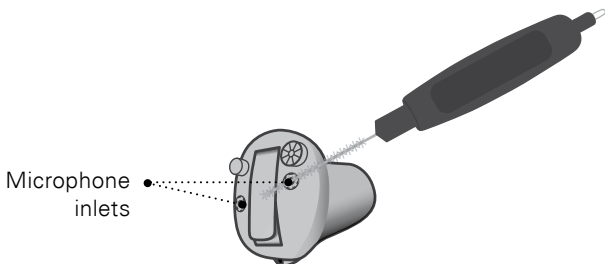

Clean the vent by pressing the brush through the hole while twisting it slightly.

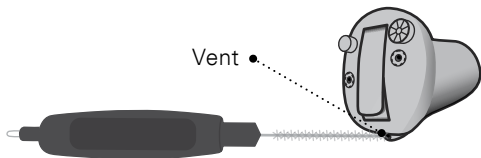

- If the vent is very small, a special tool may be required. Please consult your hearing care professional.

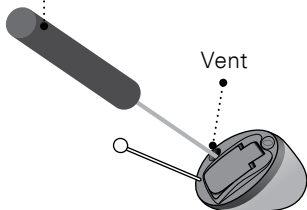

IMPORTANT NOTICE

Use a soft, dry cloth to clean the hearing aid. It must never be washed or immersed in water or other liquids.

Filter replacement

The filters keep wax and debris from damaging the hearing aid. If the filters become clogged, please replace the filters or contact your hearing care professional.

- ProWax miniFit filter protects the sound outlet.
- O-Cap and T-Cap protect the microphone inlet.

Please refer to the following pages for instructions on how to replace the appropriate filters.

IMPORTANT NOTICE

Always use the same type of wax filter as was originally supplied with the hearing aid. If you are in any doubt about the use or replacement of wax filters, contact your hearing care professional.

□ Replace ProWax miniFit filter

1. Tool

Remove the tool from the shell. The tool has two pins, one empty for removal and one with the new ProWax miniFit filter.

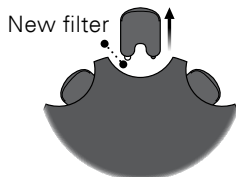

2. Remove

Push the empty pin into the ProWax miniFit filter in the hearing aid and pull it out.

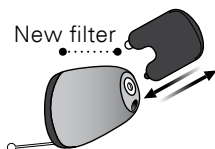

3. Insert

Insert the new ProWax miniFit filter using the other pin, remove the tool and throw it out.

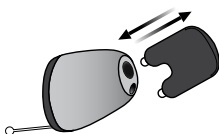

□ Replace T-Cap filter

(hearing aids with size 10 batteries)

1. Tool

Remove the tool from the packaging. The tool has two ends, one for removal and one with the new T-Cap filter.

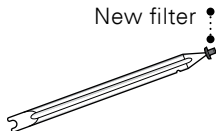

2. Remove

Push the tool fork under the top edge of the used T-Cap filter and lift it out.

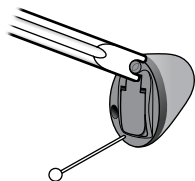

3. Insert

Insert the new T-Cap filter and remove the tool by twisting it slightly. Discard the tool after use.

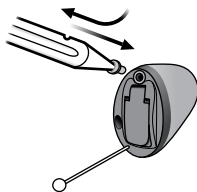

□ Replace O-Cap filter

(hearing aids with size 312 and size 13 batteries)

1. Tool

Remove the tool from the packaging. The tool has two ends, one for removal and one with the new O-Cap filter.

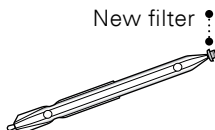

2. Remove

Push the pointed end of the tool into the existing O-Cap filter and pull it out.

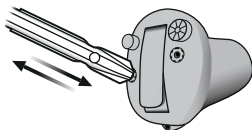

3. Insert

Insert the new O-Cap filter using the other end of the tool. Discard the tool after use.

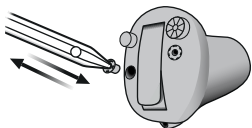

□ Flight mode

(hearing aids with Bluetooth® and push button)

When boarding an airplane or entering an area in which it is prohibited to radiate radio signals, for example during flight, flight mode must be activated. The hearing aid will still be working. It is only necessary to activate flight mode on one hearing aid, to turn off Bluetooth® on both hearing aids. If your hearing aid does not have a push button, you need to turn off your hearing aid.

To activate and deactivate

Press the push button for at least 7 seconds. A jingle confirms your action.

Opening and closing the battery drawer for each hearing aid will also deactivate the flight mode.

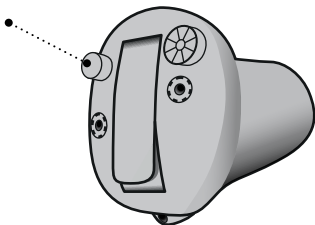

Optional features and accessories

The features and accessories described on the following pages are optional. Please contact your hearing care professional to find out how your hearing aid is programmed. If you experience difficult listening situations, a special program may be helpful. These are programmed by your hearing care professional.

Write down any hearing situations in which you may need help.

□ Change programs

Your hearing aid can have up to 4 different programs. These are programmed by your hearing care professional.

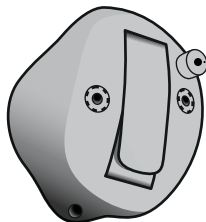

- Press the button to change program. Use a short press if the push button is used for program change only and a long press if it is also used for volume control.

Note that if you have two synchronized hearing aids (both hearing aids respond when either push button is operated), the RIGHT hearing aid switches forward from for example, program 1 to 2 and the LEFT hearing aid switches backwards from for example, program 4 to 3.

If your hearing aids work independently, you must press the buttons on each hearing aid.

To be filled out by the hearing care professional

Program	Sound you will hear when activated	When to use
----------------	---	--------------------

1	 "1 beep"	
---	--	--

2	 "2 beeps"	
---	---	--

3	 "3 beeps"	
---	---	--

4	 "4 beeps"	
---	---	--

Program change:

- | | |
|--------------------------------------|--|
| <input type="checkbox"/> Independent | <input type="checkbox"/> Synchronized* |
| <input type="checkbox"/> LEFT | <input type="checkbox"/> RIGHT |
| <input type="checkbox"/> Short press | <input type="checkbox"/> Long press |

* Only available for models with NFMI

Change volume with push button

The push button allows you to adjust the volume. You may hear a click when you turn the volume up or down.

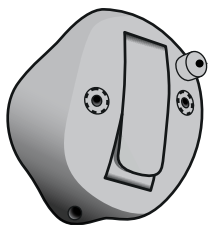

A short press on the RIGHT hearing aid increases the volume

A short press on the LEFT hearing aid decreases the volume

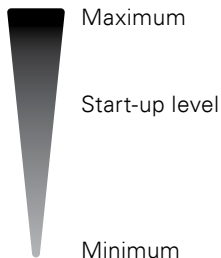

You will hear 2 beeps at the start-up level.
You will hear 3 beeps at Maximum and Minimum.

To be filled out by the hearing care professional

Volume change LEFT RIGHT

□ Change volume with volume wheel

The volume wheel allows you to adjust the volume. You may hear a click when you turn the volume up or down.

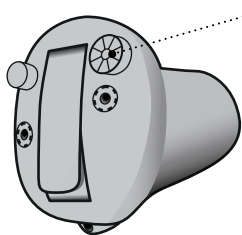

• Turn forward to
turn up volume

Turn backwards to turn
down the volume

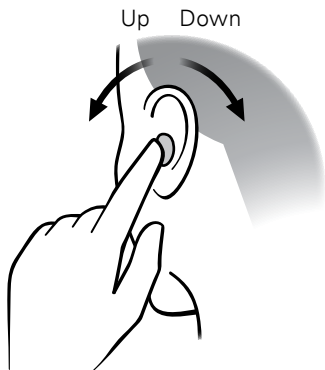

□ Mute the hearing aid

Use the mute function if you need to silence the hearing aid. Only available for hearing aids with push button.

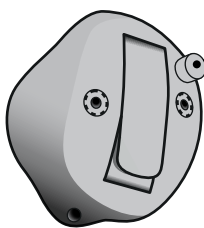

- Apply a very long press (4 seconds) to the push button to mute the hearing aid.

To reactivate the hearing aid, push the button briefly.

IMPORTANT NOTICE

Do not use the mute function as an off switch, as the hearing aid still draws current from the battery in this mode.

Using hearing aids with iPhone, iPad, and iPod touch

Your hearing aids are Made for iPhone® and allow for direct communication and control with an iPhone®, iPad® or iPod® touch.

For assistance in pairing and using these products with your hearing aid, please contact your hearing care professional or visit our support site at: www.bernafon.com/library.

Zerena is compatible with iPhone X, iPhone 8 Plus, iPhone 8, iPhone 7 Plus, iPhone 7, iPhone SE, iPhone 6s Plus, iPhone 6s, iPhone 6 Plus, iPhone 6, iPhone 5s, iPhone 5c, iPhone 5, 9.7-inch iPad Pro, 12.9-inch iPad Pro, iPad Air 2, iPad Air, iPad (4th generation), iPad mini 4, iPad mini 3, iPad mini 2, iPad mini, and iPod touch (5th and 6th generation). Devices must be running iOS 9.3 or later.

“Made for iPod”, “Made for iPhone”, and “Made for iPad” mean that an electronic accessory has been designed to connect specifically to iPod, iPhone, or iPad, respectively, and has been certified by the developer to meet Apple performance standards. Apple is not responsible for the operation of this device or its compliance with safety and regulatory standards. Please note that the use of this accessory with iPod, iPhone, or iPad may affect wireless performance.

Pairing hearing aid with iPhone

1. Settings

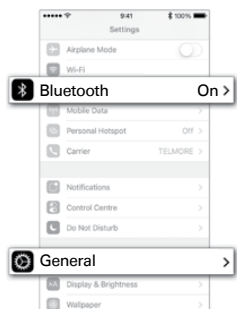

Open your iPhone and go to "Settings". Make sure Bluetooth® is on. Then choose "General".

2. General

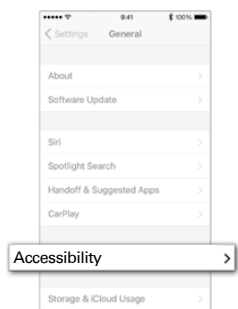

On the "General" screen, choose "Accessibility".

3. Accessibility

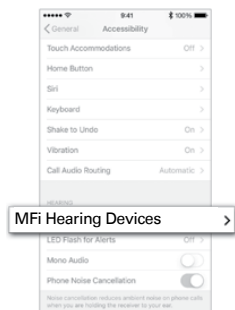

On the “Accessibility” screen, choose “MFi Hearing Devices”.

4. Prepare

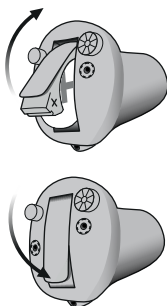

Open and close the battery drawer on both hearing aids, and place them close to your iPhone. The hearing aids remain in pairing mode for 3 minutes.

5. Select

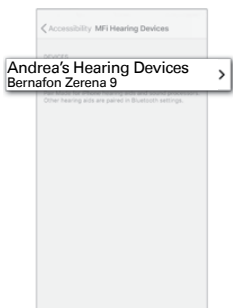

Your iPhone will detect the hearing aids for pairing. Detected devices will appear in your iPhone list. Choose your hearing aids.

6. Confirm pairing

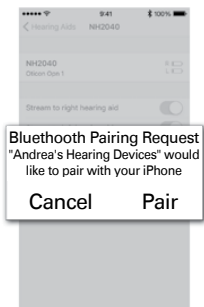

Confirm pairing. If you have two hearing aids, pairing confirmation is needed for each hearing aid.

Re-connect your hearing aids to your iPhone, iPad, or iPod touch

When you turn off your hearing aids or Apple device, these will no longer be connected. To connect them again, turn on your hearing aids by opening and closing the battery door. The hearing aids will then automatically re-connect to your Apple device.

Bernafon EasyControl-A app

Bernafon EasyControl-A app for iPhone, iPad, iPod touch, and Android™ devices offers an intuitive and discreet way to control your hearing aid. Bernafon EasyControl-A app also enables you to connect and control an endless range of other devices by linking to IFTTT via the internet.

Go to www.bernafon.com/products/accessories for more details and information on compatibility. Bernafon EasyControl-A app is available on App Store® and on Google Play™. When downloading Bernafon EasyControl-A app on iPad, search for iPhone apps on App Store.



Direct audio streaming is currently not supported by Android.



Please find more details here:
www.bernafon.com/products/accessories.

Apple, the Apple logo, iPhone, iPad, iPod touch, and Apple Watch are trademarks of Apple Inc., registered in the U.S. and other countries.

App Store is a service mark of Apple Inc. Android, Google Play, and the Google Play logo are trademarks of Google LLC.

Wireless accessories (optional)

As an enhancement to your wireless hearing aid, a range of wireless accessories are available. They can enable you to hear and communicate better in a lot of everyday situations.

SoundClip-A

When this device is paired with your mobile phone, you can use the hearing aids like stereo headphones. SoundClip-A can also function as a remote microphone and remote control.

TV-A

TV-A adapter is a wireless transmitter of sound from TV and electronic audio devices. The TV-A streams sound directly to your hearing aid.

RC-A

RC-A remote control offers the ability to change programs, adjust volume or mute your hearing aid.

Bernafon EasyControl-A app

Offers an intuitive and discreet way to control your hearing aids. For iPhone, iPad, iPod touch, and Android devices.

For more information, please contact your hearing care professional or visit:

www.bernafon.com/products/accessories.

Other options

Telecoil – only optional for some styles*

Telecoil helps you hear better when using a telephone with a built-in loop or when you are in buildings with teleloop systems such as theaters, churches, or lecture rooms. This symbol or a similar sign is shown wherever a teleloop has been installed.



Auto Telephone – only optional for some styles

The Auto Telephone can automatically activate a phone program in the hearing aid, if your telephone has a dedicated magnet. The magnet needs to be placed on your telephone next to the sound outlet.



* Be aware that when you activate 2.4 GHz and Telecoil at the same time, an artifact sound can occur

For more information, please contact your hearing care professional.

□ Tinnitus SoundSupport (optional)

Intended use of Tinnitus SoundSupport

Tinnitus SoundSupport is a tool intended to generate sounds to provide temporary relief for patients suffering from tinnitus as part of a tinnitus management program.

The target population is the adult population (over 18 years old).

Tinnitus SoundSupport is targeted to licensed hearing care professionals (audiologists, hearing aid specialists, or otolaryngologists) who are familiar with the evaluation and treatment of tinnitus and hearing loss. Fitting of Tinnitus SoundSupport must be done by a hearing care professional participating in a tinnitus management program.

Styles available with Tinnitus SoundSupport

CIC, ITC, ITE HS & ITE FS for hearing aids with push button. Please see the model overview to find out which style your hearing aid is.

Guidelines for tinnitus sound generator users

These instructions contain information about Tinnitus SoundSupport, which may have been enabled in your hearing aids by your hearing care professional.

Tinnitus SoundSupport is a tinnitus management device intended to generate sound of sufficient intensity and bandwidth to help manage tinnitus.

Your hearing care professional will also be able to offer the appropriate follow-up care. It is important to follow his/her advice and directions regarding such care.

Prescription use only

Good health practice requires that a person reporting tinnitus has had a medical evaluation by a licensed ear physician before using a sound generator. The purpose of such an evaluation is to ensure that any medically treatable condition that may cause tinnitus is identified and treated prior to using a sound generator.

Sound options and volume adjustment

Tinnitus SoundSupport is programmed by your hearing care professional to match your hearing loss and preferences for tinnitus relief. It offers a number of different sound options. Together with your hearing care professional, you can select your preferred sound(s).

Tinnitus SoundSupport programs

Together with your hearing care professional, you decide for which programs you may want to have Tinnitus SoundSupport activated. The sound generator can be activated in up to four different programs.

Mute

If you are in a program for which Tinnitus SoundSupport is activated, the mute functionality will mute only the environmental sounds, and not the sound from Tinnitus SoundSupport. See chapter: “Mute the hearing aid”.

Volume adjustments with Tinnitus SoundSupport

When you select a hearing aid program for which Tinnitus SoundSupport is activated, your hearing care professional can only set the push button on your hearing aid to work as a volume control for the tinnitus relief sound.

Your hearing care professional will set the volume control for the sound generator in one of two ways:

- A) change volume in each ear separately, or
- B) change volume in both ears simultaneously.

Change volume with push button

See section “Change volume with push button” for illustration.

A) How to change Tinnitus SoundSupport volume in each ear separately

To **increase** volume (on one hearing aid only), use a short press on the push button repeatedly until desired level is reached. The sound will always be louder with the first press(es) until two beeps are heard. Hereafter, the volume will **decrease**.

To **decrease** volume (on only one hearing aid), continue to press the push button repeatedly until desired level is reached.

B) How to change Tinnitus SoundSupport volume in both ears simultaneously

You can use one hearing aid to **increase** the sound and the other hearing aid to decrease the sound.

To **increase** volume, use a short press on the push button repeatedly on the RIGHT hearing aid.

To **decrease** volume, use a short press on the push button repeatedly on the LEFT hearing aid.

To be filled out by your hearing care professional.

Change volume with volume wheel

See section “Change volume with volume wheel” for illustration.

A) How to change Tinnitus SoundSupport volume in each ear separately

To **increase** volume (on one hearing aid only), turn the volume wheel forward.

To **decrease** volume (on one hearing aid only), turn the volume wheel backwards.

B) How to change Tinnitus SoundSupport volume in both ears simultaneously

You can use one hearing aid to increase/decrease the sound in both hearing aids. When changing the volume in one hearing aid, the volume on the other hearing aid will follow.

To **increase** volume, turn the volume wheel forward.

To **decrease** volume, turn the volume wheel backwards.

To be filled out by your hearing care professional.

□ Hearing aid with Bluetooth®

If your hearing aid has Bluetooth® connection, you will be able to adjust the environmental sounds in a program with Tinnitus SoundSupport with EasyControl-A or SoundClip-A.

EasyControl-A app for iPhone, iPad, iPod touch, and Android™ devices offers the possibility to adjust both the environmental sound and the Tinnitus SoundSupport in each program directly from the app.

Limitation on use time

Daily use

The volume levels of Tinnitus SoundSupport can be set to a level which could lead to permanent hearing damage when used for a prolonged period of time. Your hearing care professional will advise you of the maximum amount of time per day you should use Tinnitus SoundSupport. It should never be used at uncomfortable levels.

See table “Tinnitus SoundSupport: Limitation on use” at the end of this booklet to learn how many hours per day you can safely use the relief sound in your hearing aids.

Important information for hearing care professionals about Tinnitus SoundSupport

Device description

Tinnitus SoundSupport is a module function that can be enabled in the hearing aids by the hearing care professional.

Maximum wearing time

The wearing time of Tinnitus SoundSupport will decrease as you increase the level above 80 dB(A) SPL. The fitting software will automatically display a warning when the hearing aid exceeds 80 dB(A) SPL. See “max wearing time indicator” next to the tinnitus fitting graph in the fitting software.

The volume control is deactivated

By default, the volume control for the sound generator is deactivated in the hearing aid. Risk of noise exposure increases when the volume control is activated.

If the volume control is activated

A warning may be displayed if you activate the tinnitus volume control in the “Buttons & Indicators” screen. This occurs if the relief sound can be listened to at levels that may cause hearing damage. The “Limitation on Use” table in the fitting software displays the number of hours the patient can safely use Tinnitus SoundSupport.

- Note the max wearing time for each program for which Tinnitus SoundSupport is activated.
- Write those values in the table:
“Tinnitus SoundSupport: Limitation on use”,
in the back of this booklet.
- Instruct your patient accordingly.

The Tinnitus SoundSupport is manufactured for Bernafon AG.

⚠ Warnings related to Tinnitus SoundSupport

If your hearing care professional has activated the sound generator Tinnitus SoundSupport, please pay attention to the following warnings.

There are some potential concerns associated with the use of any sound generated by a tinnitus management device. Among them are the potential worsening of tinnitus, and/or a possible change in hearing thresholds.

Should you experience or notice a change in hearing or tinnitus, or any dizziness, nausea, headaches, heart palpitations, or possible skin irritation at the point of contact with the device, you should immediately discontinue use of the device and consult a medical, audiology, or other hearing care professional.

As with any device, misuse of the sound generator feature may cause potentially harmful effects. Care should be taken to prevent unauthorized use and to keep the device out of reach of children and pets.

Maximum wearing time

Always follow the maximum wearing time per day of the Tinnitus SoundSupport advised by your hearing care professional. Prolonged use may lead to worsening of your tinnitus or of your hearing loss.

⚠ General warnings

You should familiarize yourself fully with the following general warnings before using your hearing aid for your personal safety and to ensure correct use.

Please note that a hearing aid will not restore normal hearing and will not prevent or improve a hearing impairment resulting from organic conditions. Furthermore, note that in most cases, infrequent use of a hearing aid does not permit a user to attain full benefit from it.

Consult your hearing care professional if you experience unexpected operations or events with your hearing aid.

Usage of hearing aids

- Hearing aids should be used only as directed and adjusted by your hearing care professional. Misuse can result in sudden and permanent hearing loss.
- Never allow others to wear your hearing aid, as incorrect usage could cause permanent damage to their hearing.

Choking hazards & risk of swallowing batteries and other small parts

- Hearing aids, their parts, and batteries should be kept out of reach of children and anyone who might swallow these items or otherwise cause injury to themselves.
- Batteries have occasionally been mistaken for pills. Therefore, check your medicine carefully before swallowing any pills.
- Most hearing aids can be supplied with a tamper-resistant battery drawer upon request. This is strongly recommended for infants, small children, and people with learning difficulties.
- Children younger than 36 months must always use a tamper-resistant battery drawer. Please talk to your hearing care professional about the availability of this option.

If a battery or hearing aid is swallowed, see a doctor immediately.

Battery use

- Always use batteries recommended by your hearing care professional. Batteries of low quality may leak and cause bodily harm.
- Never attempt to recharge your batteries, and never dispose of batteries by burning them. There is a risk that the batteries will explode.

General warnings

Dysfunction

- Be aware of the possibility that your hearing aid may stop working without notice. Keep this in mind when you depend on warning sounds (for example when you are in traffic). The hearing aids may stop functioning, for instance if the batteries have expired or if the tubing is blocked by moisture or ear wax.

Active implants

- Caution must be taken with active implants. In general, follow the guidelines recommended by manufacturers of implantable defibrillators and pacemakers regarding use with mobile phones and magnets.
- The Auto Telephone magnet and MultiTool (which has a built-in magnet) should be kept more than 30 cm away from the implant, for example, do not carry it in a breast pocket.
- If you have an active brain implant, please contact the manufacturer of your implantable device for information about the risk of disturbance.

X-ray, CT, MR, PET scanning and electrotherapy

- Remove your hearing aid before X-ray, CT/MR/PET scanning electrotherapy, surgery etc. as your hearing aid may be damaged when exposed to strong fields.

Heat and chemicals

- The hearing aid must never be exposed to extreme heat, for example, left inside a parked car in the sun.
- The hearing aid must not be dried in microwave ovens or other ovens.
- The chemicals in cosmetics, hairspray, perfume, aftershave lotion, suntan lotion and insect repellent can damage the hearing aid. Always remove your hearing aid before applying such products and allow time to dry before use.

Power instrument

- Special care should be exercised in selecting, fitting and using a hearing aid where maximum sound pressure capability exceeds 132 dB SPL (IEC 711), as there may be risk of impairing the remaining hearing of the hearing aid user.

For information on whether your hearing aid is a power instrument, see the "Model overview" section in the front of this booklet.

Possible side effects

- Hearing aids and earpieces may cause an accelerated accumulation of ear wax.
- The otherwise non-allergenic materials used in hearing aids may in rare cases cause a skin irritation or other side effects.

Please seek consultation with a physician if these conditions occur.

General warnings

Interference

- The hearing aid has been thoroughly tested for interference, according to the most stringent international standards. However, interference between the hearing aid and other devices (e.g. some mobile telephones, citizens band systems and shop alarm systems and other devices) may occur. If this occurs, increase the distance between the hearing aid and the interfering device.

Use on aircraft

- Your hearing aid contains Bluetooth®. On board an aircraft, flight mode must be activated, unless Bluetooth® is permitted by the flight personnel.

Please see the model overview to see if your hearing aid has Bluetooth®.

Connection to external equipment

- The safety of the hearing aid when connected to external equipment with an auxiliary input cable and/or with a USB cable and/or directly, is determined by the external signal source. When connected to external equipment plugged into a wall outlet, this equipment must comply with IEC-62368 (or IEC-60065, IEC-60950 until June 20, 2019) or equivalent safety standards.

Troubleshooting guide

Symptom	Possible causes
No sound	Dead battery
	Clogged sound outlet
	Clogged microphone inlet
	Hearing aid microphone muted
Intermittent or reduced sound	Clogged sound outlet
	Moisture
	Dead battery
Squealing noise	Hearing aid not inserted properly
	Ear wax accumulated in ear canal
Pairing issue with Apple device	Bluetooth® connection failed
	Only one hearing aid paired

Solutions

Replace the battery

Clean sound outlet* or replace the wax filter

Clean microphone inlet* or replace filter
(T-Cap or O-Cap)

Un-mute the hearing aid microphone

Clean sound outlet or replace the wax filter

Wipe battery and hearing aid with a dry cloth

Replace the battery

Re-insert the hearing aid

Have ear canal examined by your doctor

1. Unpair your hearing aids
(Settings → General → Accessibility → Hearing Devices → Devices → Forget this device).
 2. Turn Bluetooth® off and on again.
 3. Open and close battery drawer on hearing aids.
 4. Re-pair hearing aids (see section “Pair Hearing Aids with iPhone”).
-

* According to guideline in this booklet

If none of the above solutions work, consult your hearing care professional for assistance.

Water & dust resistance (IP68)

Your hearing aid is dust-tight and protected against ingress of water which means it is designed to be worn in all daily life situations. Therefore, you do not have to worry about sweat or getting wet in the rain. Should your hearing aid come in contact with water and stop working, please follow these guidelines:

1. Gently wipe off any water.
2. Open the battery drawer and remove the battery and gently wipe off any water in the battery drawer.
3. Let the hearing aid dry with the battery drawer left open for approximately 30 minutes.
4. Insert a new battery.

IMPORTANT NOTICE

Do not wear your hearing aid while showering or participating in water activities. Do not immerse your hearing aid in water or other liquids.

Conditions of use

Operating conditions	Temperature: +1 °C to +40 °C Relative humidity: 5 % to 93 %, non-condensing
----------------------	--

Storage and transportation conditions	Temperature and humidity should not exceed the following limits for extended periods during transportation and storage: Temperature: –25 °C to +60 °C Relative humidity: 5 % to 93 %, non-condensing
---------------------------------------	--

Warranty certificate

Name of owner:

Hearing care professional:

Hearing care professional address:

Hearing care professional phone:

Purchase date:

Warranty period:

Month:

Model right:

Serial no.:

Model left:

Serial no.:

Battery size:

International warranty

Your hearing aid is covered by an international limited warranty issued by the manufacturer for a period of 12 months from the date of delivery. This limited warranty covers manufacturing and material defects in the hearing aid itself, but not in accessories such as batteries, tubing, speakers, earpieces and filters, etc. Problems arising from improper/incorrect handling or care, excessive use, accidents, repairs made by an unauthorized party, exposure to corrosive conditions, physical changes in your ear, damage due to foreign objects entering the device or incorrect adjustments are NOT covered by the limited warranty and may void it. The above warranty does not affect any legal rights that you might have under applicable national legislation governing sale of consumer goods. Your hearing care professional may have issued a warranty that goes beyond the clauses of this limited warranty. Please consult him/her for further information.

If you need service

Take your hearing aid to your hearing care professional, who may be able to sort out minor problems and adjustments immediately.

Technical information

The hearing aid contains two radio technologies, which are described below:

The hearing aid contains a radio transceiver using short range magnetic induction technology working at 3.84 MHz. The magnetic field strength of the transmitter is very weak and is always below $-40 \text{ dB}\mu\text{A/m}$ at a 10 meter distance.

The hearing aid also contains a radio transceiver using Bluetooth® Low Energy (BLE) and a proprietary short range radio technology both working at ISM band 2.4 GHz. The radio transmitter is weak and is always below 4.8 dBm e.i.r.p. in total radiated power.

The hearing aid complies with international standards concerning electromagnetic compatibility and human exposure.

Due to the limited space available on the hearing aid, relevant approval markings can be found in this document.

Additional information can be found in the "Product Information" on www.bernafon.com.

USA and Canada

The hearing aid contains a radio module with the following certification ID numbers:

CIC NFMI instruments contain a module with:

FCC ID: U6XAUCIC

IC: 7031A-AUCIC

ITC, ITE HS & ITE FS 2.4 GHz instruments contain a module with:

Battery size 13:

FCC ID: U6XAUITE13

IC: 7031A-AUITE13

Battery size 312:

FCC ID: U6XAUITE312

IC: 7031A-AUITE312

The device complies with Part 15 of the FCC Rules and with Industry Canada's licence-exempt RSSs.

Operation is subject to the following two conditions:

1. This device may not cause harmful interference.
2. This device must accept any interference received, including interference that may cause undesired operation.

The manufacturer declares that this hearing aid is in compliance with the essential requirements and other relevant provisions of Directive 2014/53/EU.

Declaration of Conformity is available from the manufacturer.

Bernafon AG
Morgenstrasse 131
CH-3018 Bern
Switzerland

CE 0543



Waste from electronic equipment must be handled according to local regulations.

 **Bluetooth®**



IP68

Your individual hearing aid settings

To be filled out by your hearing care professional.

Settings overview for your hearing aid

Left			Right	
<input type="checkbox"/> Yes	<input type="checkbox"/> No	Volume control	<input type="checkbox"/> Yes	<input type="checkbox"/> No
<input type="checkbox"/> Yes	<input type="checkbox"/> No	Program shift	<input type="checkbox"/> Yes	<input type="checkbox"/> No
<input type="checkbox"/> Yes	<input type="checkbox"/> No	Mute	<input type="checkbox"/> Yes	<input type="checkbox"/> No
<input type="checkbox"/> Yes	<input type="checkbox"/> No	Tinnitus SoundSupport	<input type="checkbox"/> Yes	<input type="checkbox"/> No







Volume control indicators







<input type="checkbox"/> On	<input type="checkbox"/> Off	Beeps at min/max volume	<input type="checkbox"/> On	<input type="checkbox"/> Off
<input type="checkbox"/> On	<input type="checkbox"/> Off	Clicks when changing volume	<input type="checkbox"/> On	<input type="checkbox"/> Off
<input type="checkbox"/> On	<input type="checkbox"/> Off	Beeps at preferred volume	<input type="checkbox"/> On	<input type="checkbox"/> Off

Battery indicators

<input type="checkbox"/> On	<input type="checkbox"/> Off	Low battery warning	<input type="checkbox"/> On	<input type="checkbox"/> Off
-----------------------------	------------------------------	---------------------	-----------------------------	------------------------------

Description of symbols used in this booklet or on the packaging label

	<p>Warnings Text marked with a marking symbol must be read before using the product.</p>
	<p>Manufacturer The product is produced by the manufacturer whose name and address are stated next to the symbol. Indicates the medical device manufacturer, as defined in EU Directives 90/385/EEC, 93/42/EEC and 98/79/EC.</p>
	<p>CE mark The product complies with Medical Device Directive 93/42/EEC. The four digits number indicates the identification of the notified body.</p>
	<p>Electronic waste (WEEE) Recycle your hearing aids, accessories or batteries according to local regulations or return them to your hearing care professional for disposal. Electronic equipment covered by Directive 2012/19/EU on waste and electrical equipment (WEEE).</p>
	<p>Regulatory Compliance Mark (RCM) The product complies with electrical safety, EMC and radio spectrum requirements for products supplied to the Australian or New Zealand market.</p>
	<p>IP code This symbol indicates the class of protections against harmful ingress of water and particulate matter according to EN 60529:1991/A1:2002. IP6X indicates total dust protection. IPX8 indicates the protection against the effects of continuous immersion in water.</p>

	<p>Bluetooth® logo Registered trademark of Bluetooth® SIG, Inc. where any use of such requires a license.</p>
	<p>Made for iPod, iPhone, and iPad Indicates that the device is compatible with iPod, iPhone and iPad. Description of symbols used on the packaging label.</p>
	<p>Keep dry Indicates a medical device that needs to be protected from moisture.</p>
	<p>Caution symbol Consult instructions for use for warnings and cautions.</p>
	<p>Catalogue number Indicates the manufacturer's catalogue number so that the medical device can be identified.</p>
	<p>Serial number Indicates the manufacturer's serial number so that a specific medical device can be identified.</p>

Tinnitus SoundSupport: Limitation on use

No limitation on use

Program	Start-up volume (Tinnitus)	Max volume (Tinnitus)
<input type="checkbox"/> 1	Max ____ hours per day	Max ____ hours per day
<input type="checkbox"/> 2	Max ____ hours per day	Max ____ hours per day
<input type="checkbox"/> 3	Max ____ hours per day	Max ____ hours per day
<input type="checkbox"/> 4	Max ____ hours per day	Max ____ hours per day

Ref. OSHA (Occupational Safety & Health Administration, U.S. department of Labour) / DIRECTIVE 2003/10/EC on the minimum health and safety requirements regarding the exposure of workers to the risks arising from physical agents (noise) / Occupational exposure to noise: evaluation, prevention and control – Special Report S 64, WHO.

< >
8,15 mm

Placeholder
for FSC logo
FSC
MIX
Paper
FSC® C043870

^
19 mm
v

^
9,0 mm
v
< 15 mm >

Australia

Bernafon Australia
629 Nudgee Road
Nundah QLD 4012
Freecall 1800 809 111
Phone +61 7 3250 0300
info@bernafon.com.au

United Kingdom

Bernafon UK
Cadzow Industrial Estate
Off Low Waters Road
Hamilton
ML3 7QE Scotland
Phone + 44 1698 285 968
info@bernafon.co.uk

New Zealand

Bernafon New Zealand
Millennium Centre
Level 2, Building A
600 Great South Road
Greenlane, Auckland 1051
Toll Free 0800 442 257
info@bernafon.co.nz

South Africa

Bernafon South Africa (Pty) Ltd
39 Van Vuuren Street
Constantia Kloof
1709
Phone + 27 11 675 6104



Manufacturer:

Bernafon AG
Morgenstrasse 131
3018 Bern
Switzerland
www.bernafon.com



0000190430000001

bernafon 
Your hearing • Our passion