

# ECKEL **EASY ACCESS** AUDIOLOGICAL ROOMS



**LO-PROFILE  
FLOOR DESIGN**

**OUTSTANDING  
NOISE REDUCTION**

**CL-SERIES CAM LOCK  
PANEL SYSTEM**

**MANY SIZES  
AND OPTIONS**

## **QUALITY ENGINEERED**

**SOUND ISOLATION ROOMS FOR  
AUDIOLOGISTS • DOCTORS  
HEARING AID SPECIALISTS  
CLINICS**

**Designed to allow easy access by reducing the floor, permitting a flush entrance**

*Innovative audiometric rooms and suites for all audiological measurements and research, combine excellent performance and versatile design • Choice of eight standard models of 4" thick single-wall Eckel Audiometric Rooms are offered to meet most needs.*

### **EXCELLENT ACOUSTIC CHARACTERISTICS**

Wall, ceiling and floor provide outstanding noise reduction. Panels are connected and secured to each other using a special cam locking panel design. The acoustic door, which incorporates a continuous magnetic seal, has an acoustic attenuation comparable to that of the walls.

**COMPLETELY ISOLATED** Structurally borne noise is effectively isolated through the unit's specially designed floor.

**VERSATILE** The standard, built-in jack panel adapts to all audiometers. Doctors, audiologists and hearing aid dispensers not only can conduct a full range of diagnostic measurements necessary to properly fit a person with a

hearing aid, but also can perform all audiological assessments.

**EXCELLENT VISIBILITY** A 24" x 30" built-in double-glazed, 1/4" acoustic glass window assures the integrity of the room's performance and permits visual observation and monitoring, and prevents any feeling of claustrophobia.

**COMFORTABLE TO USE** The spacious interior has an independent silenced power ventilation system with noise level below the binaural threshold of hearing. It supplies at least 12 air changes an hour, keeping the room fresh and pleasant.

**IN-PLACE LIGHTING** 2-bulb wall-mounted fixture provides good interior illumination.

**ATTRACTIVE** The interior and exterior of the rooms are finished with a durable paint to assure a handsome, long-lasting appearance. Standard colour is light beige - other colours are optional.

### **NOISE REDUCTION**

Hz	dB
125	19
250	30
500	39
1000	50
2000	58
4000	60

### **STANDARD FEATURES**

34 1/2" x 75" clear opening door. 24" x 30" double-glazed 1/4" acoustic window • Jack panel • Ventilation Lighting • Carpeting • Window in door option. Easy to install, take down and move. No caulking - acoustic seal between panels is accomplished with Acoustical Rubber Seals. Electricity: plug in and use. **Options:** Special colours • Extra windows • Air conditioning • Key locks • Extra duplex outlets.

*When ordering, specify door swing (left hand or right hand). A sketch of the proposed arrangement of examination area will help ensure satisfaction.*

Box 776 15 Allison Ave. Morrisburg ON K0C 1X0  
Tel: 613-543-2967 800-563-3574 Fax: 613-543-4173  
Web site: [www.eckel.ca](http://www.eckel.ca) E-mail: [eckel@eckel.ca](mailto:eckel@eckel.ca)

**ECKEL**  
NOISE CONTROL TECHNOLOGIES

# WE OFFER SEVERAL PLANS...CHOOSE ONE FOR YOUR OFFICE

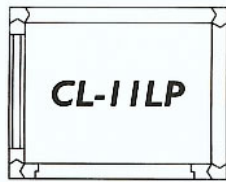

	W.	D.	H.
I.D.	1118 mm	838 mm	1981 mm
O.D.	1321 mm	1041 mm	2184 mm
I.D.	3' 8"	2' 9"	6' 6"
O.D.	4' 4"	3' 5"	7' 2"

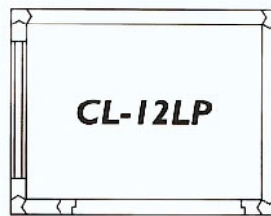

	W.	D.	H.
I.D.	1397 mm	1118 mm	1981 mm
O.D.	1600 mm	1321 mm	2184 mm
I.D.	4' 7"	3' 8"	6' 6"
O.D.	5' 3"	4' 4"	7' 2"

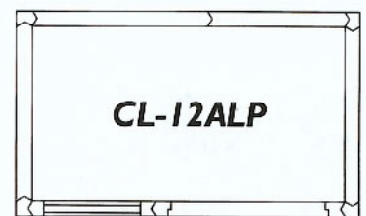

	W.	D.	H.
I.D.	1956 mm	1118 mm	1981 mm
O.D.	2159 mm	1321 mm	2184 mm
I.D.	6' 5"	3' 8"	6' 6"
O.D.	7' 1"	4' 4"	7' 2"

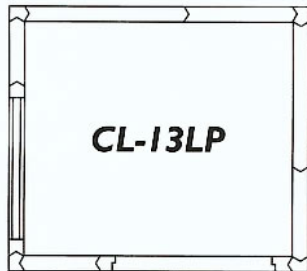

	W.	D.	H.
I.D.	1676 mm	1397 mm	1981 mm
O.D.	1880 mm	1600 mm	2184 mm
I.D.	5' 6"	4' 7"	6' 6"
O.D.	6' 2"	5' 3"	7' 2"

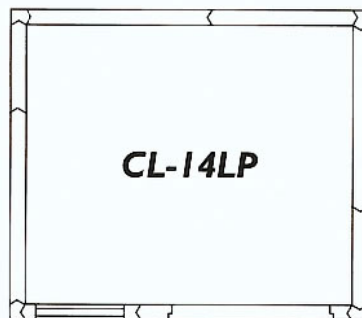

	W.	D.	H.
I.D.	1956 mm	1676 mm	1981 mm
O.D.	2159 mm	1880 mm	2184 mm
I.D.	6' 5"	5' 6"	6' 6"
O.D.	7' 1"	6' 2"	7' 2"

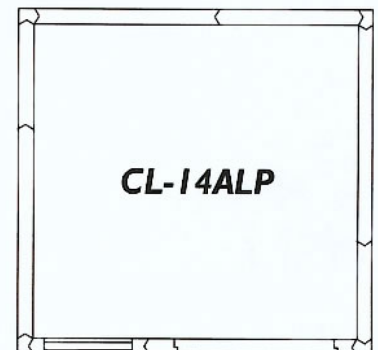

	W.	D.	H.
I.D.	1956 mm	1956 mm	1981 mm
O.D.	2159 mm	2159 mm	2184 mm
I.D.	6' 5"	6' 5"	6' 6"
O.D.	7' 1"	7' 1"	7' 2"

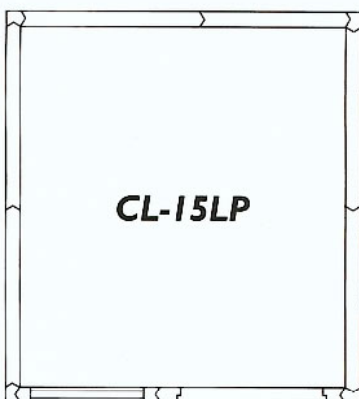

	W.	D.	H.
I.D.	1956 mm	2235 mm	1981 mm
O.D.	2159 mm	2438 mm	2184 mm
I.D.	6' 5"	7' 4"	6' 6"
O.D.	7' 1"	8' 0"	7' 2"

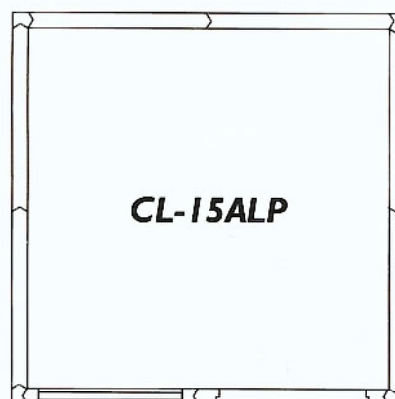

	W.	D.	H.
I.D.	2235 mm	2235 mm	1981 mm
O.D.	2438 mm	2438 mm	2184 mm
I.D.	7' 4"	7' 4"	6' 6"
O.D.	8' 0"	8' 0"	7' 2"

DEALER / DISTRIBUTOR



When ordering, specify door swing (left hand or right hand). A sketch of the proposed arrangement of examination area will help ensure satisfaction.

**ECKEL**  
NOISE CONTROL TECHNOLOGIES

Box 776 15 Allison Ave. Morrisburg ON K0C 1X0  
Tel: 613-543-2967 800-563-3574 Fax: 613-543-4173  
Web site: [www.eckel.ca](http://www.eckel.ca) E-mail: [eckel@eckel.ca](mailto:eckel@eckel.ca)