

# New Tamper Resistant Battery Doors

## for Oticon Opn Play BTE PP and Oticon Xceed Play BTE SP Hearing Instruments

Child safety has always been a primary concern at Oticon. Tamper resistant battery doors are standard on our pediatric hearing aids for ages 0-3. They are also available upon request for older children and adults to prevent access to the hearing instrument's batteries.



### Recent enhancements to Oticon Opn Play BTE PP and Oticon Xceed Play BTE SP tamper resistant battery doors

The tamper resistant battery doors mounted on our Opn Play BTE PP and Xceed Play BTE SP hearing aids have recently been enhanced to provide greater ease of use.

A new green service tool, new right/left markers and an updated user guide will be included with hearing aids with the new tamper resistant doors to allow you to safely open and close the doors.

### How to open the new tamper resistant battery doors

1. Hold the hearing aid with the ear hook pointing upwards on the left and the battery door on the right. Locate the small hole on the battery door and insert the green tool into the hole. Gently push the pin tip further into the hole. (A)
2. Lift the green tool up towards the ear hook. This will release the spring that holds the door shut and the battery door will open. (B,C)

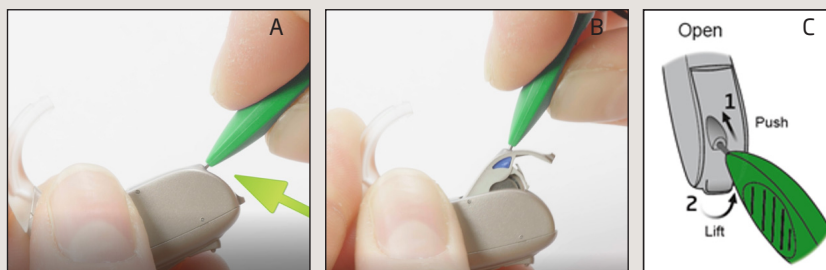

**Important Note: The redesigned tamper resistant battery doors utilize new right/left markers and the new green tool should be used to open the doors. The old right/left markers used with our previous tamper resistant battery doors will not work with these new doors.**

**Please note** that for patients using FM receivers and adapters, the original battery door should continue to be used. Our current doors will still be available upon request for patients with FM needs.

### Spare parts stock of new tamper resistant battery doors

Spare parts stock of the new tamper resistant battery doors is also available. Please call Pediatric Customer Service at **888.684.7331** with your requests. Green service tools, new right/left markers and user guides will also be included with these doors.

Please contact Oticon Pediatrics at **888.684.7331** if we can assist you with any other service needs.